

SCHEDULE OF ROOMS			
TYPE	SQ. UNIT	SIZE	REMARKS
D	-	2400	1800X2400
D1	-	2400	1800X2400
D2	-	2400	1000X2400
D3	-	2400	900X2400
D4	-	2100	750X2100
F01	-	2400	1200X2400
F02	-	2400	1800X2400

SCHEDULE OF WINDOWS			
TYPE	SQ. UNIT	SIZE	REMARKS
W3	1050	2400	1200X1150
W4	900	2400	900X1150
V	1200	2100	600X1950
WS	900	2400	1800X1150
RS	100	800X800	AS PER PLAN

SIGNATURE OF OWNER
MAHESH KUMAR AGARWAL
 SANKARU NEWS AND ALLED SERVICES PVT LTD
 ADDRESS: 23A, A.C BOSE ROAD, CHITRANKOOT BUILDING, 7TH FLOOR
 KOLKATA - 700015

CERTIFICATE OF ARCHITECT
 I CERTIFY THAT ALL THE ARCHITECTURAL DRAWINGS OF THE PROJECT AT
 PRESENTED NO. 23/A, BOSE ROAD, CHITRANKOOT BUILDING, 7TH FLOOR,
 KOLKATA - 700015, HAVE BEEN PREPARED BY THE ARCHITECTING
 FIRM AND DRAWINGS PREPARED BY ME COMPLY WITH ALL APPLICABLE
 CODES AND STANDARDS AND THE SAME ARE IN ACCORDANCE WITH THE
 PREVALENT NATIONAL BUILDING CODES AS FORTH IN MANY OF THE DRAWINGS AND
 FOR REFERENCE AND SUBMITTED TO THE SANCTIONING AUTHORITY

SIGNATURE OF ARCHITECT
RAJAGAN AGARWAL
 ARCHITECT/INDIAN.

CERTIFICATE OF STRUCTURAL ENGINEER
 I CERTIFY THAT THE STRUCTURAL DRAWING AND DESIGN OF BOTH THE
 MAJOR AND MINOR PORTIONS OF THE STRUCTURE HAVE BEEN
 MADE CONSIDERING THE SOIL TEST REPORT ASPECTS, WIND LOADS AND
 SEISMIC LOADS AND THE EVIDENCE GENERATED BY THE PROPOSED
 FOUNDATION AND THE EVIDENCE GENERATED BY THE PROPOSED
 FOUNDATION AND THE EVIDENCE GENERATED BY THE PROPOSED
 FOUNDATION SHALL BE ADVISED TO OBTAIN THE CONSTRUCTION

SIGNATURE OF STRUCTURAL ENGINEER
STERNKONDA/INDIAN
 THIS STATEMENT HAS BEEN PREPARED BY ME AS A TECHNICAL REPORT FOR SOIL
 INVESTIGATION HAS BEEN MADE BY ME FOR DESIGN AND CALCULATION OF
 FOUNDATION AND THE EVIDENCE GENERATED BY THE PROPOSED
 FOUNDATION AND THE EVIDENCE GENERATED BY THE PROPOSED
 FOUNDATION SHALL BE ADVISED TO OBTAIN THE CONSTRUCTION

SIGNATURE OF GEOTECHNICAL ENGINEER
QTESH/INDIAN

TITLE
FIRST, SECOND & THIRD FLOOR PLAN.

PROJECT
**PROPOSED PLAN OF B+G+IX STORED
 BUSINESS BUILDING AT PREMISES NO:
 03-0775, PLOT NO.-IID/24, ACTON
 AREA-IID, NEWTOWN,
 KOLKATA-700161, UNDER NEWTOWN P.S.
 KOLKATA.**

DATE	JOB NO.	DEALTY	SCALE	SHEET NO.
27.03.23	ARCH/2023/788	POU/AM	1:100	2/9

ARCHITECTURAL DRAWING-02/08
RAJ AGARWAL & ASSOCIATES
 8B, ROYD STREET, KOLKATA - 16

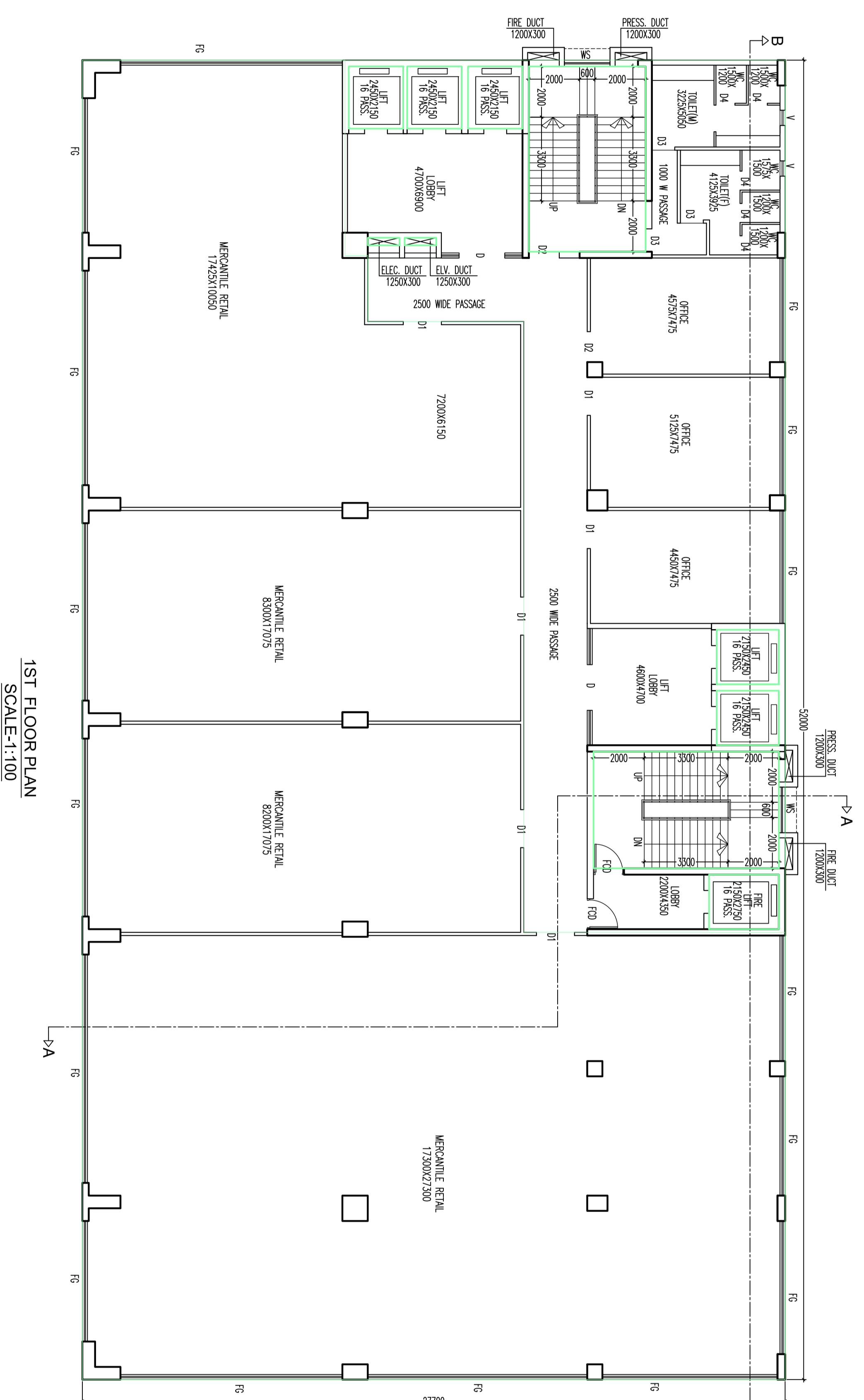

1ST FLOOR PLAN
SCALE: 1:100

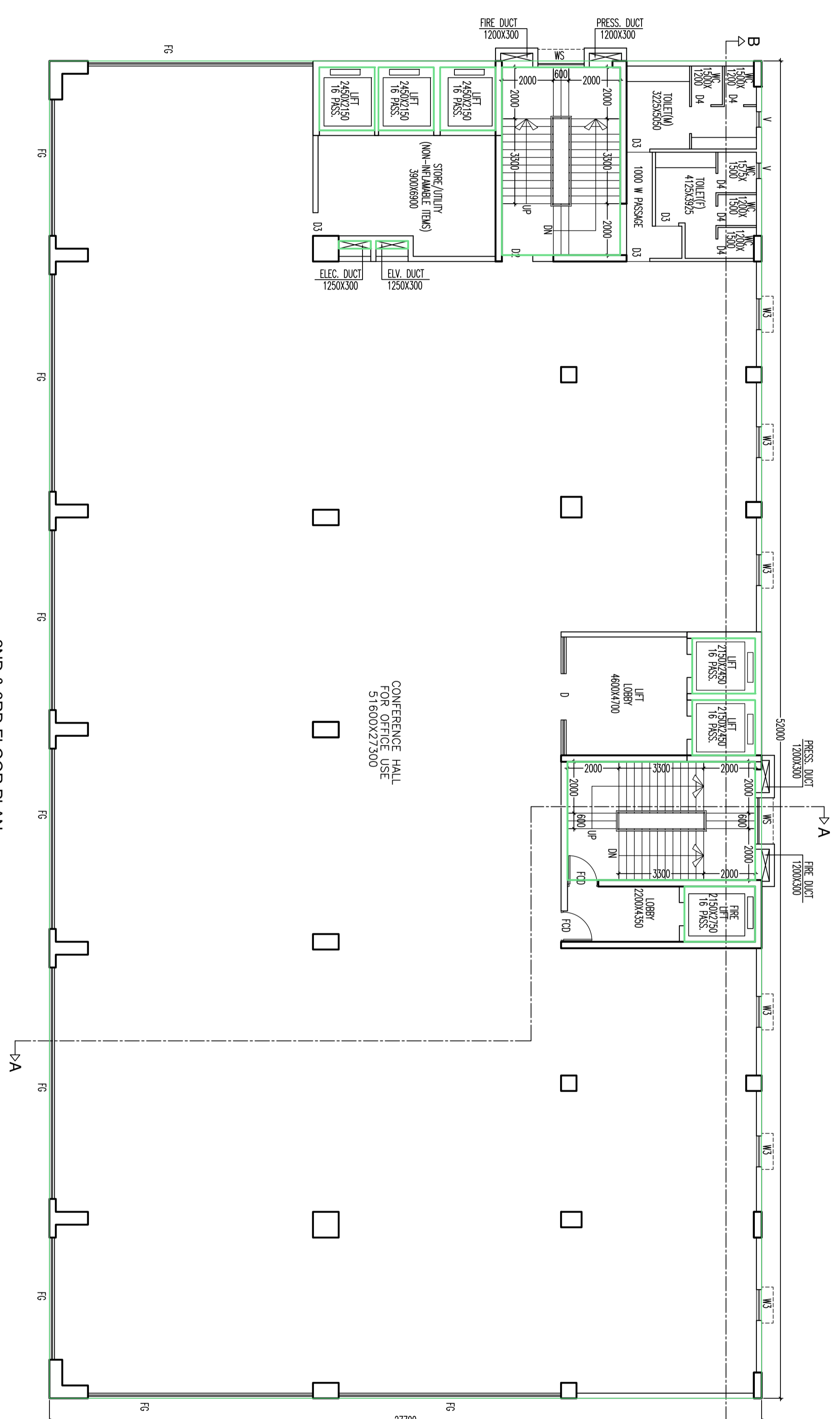

2ND & 3RD FLOOR PLAN
SCALE: 1:100